

RAILEX SYSTEM 420

PENDANT UP POWER TUBE CONVEYOR

The Railex System 420 power tube conveyor moves garments along a steel track by pushing the hangers that lay on the track. Since Railex introduced the System 420 we have installed hundreds of systems and tens-of-thousands of feet of conveyor rail and chain. The 420 is designed for conveyor garments and similar items on wire hangers horizontally and on inclines in all directions. The 420 can follow almost any desired path through your facility.

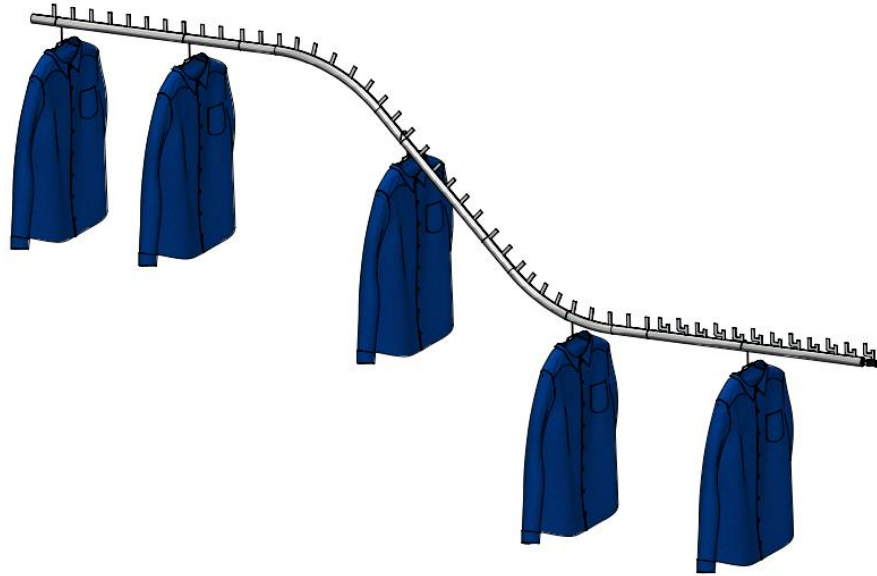

Chain Type

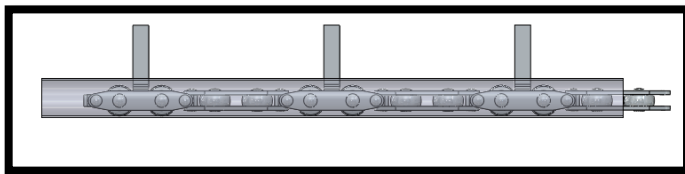

421-C6P

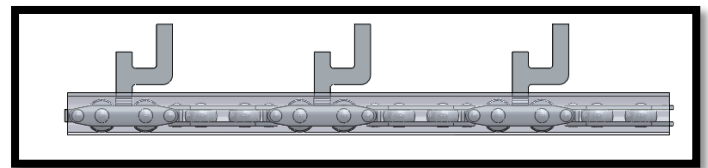

421-C6UC

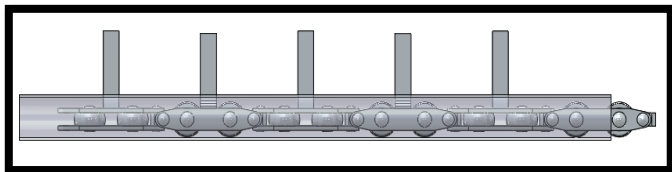

421-C3P

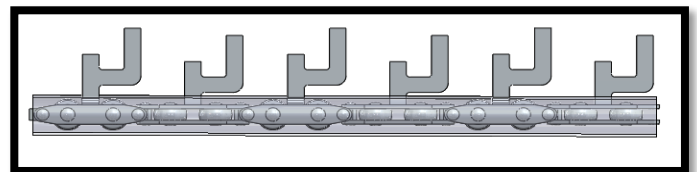

421-C3UC



G2 Rail
Support



CB2 Rail
Support

Curves

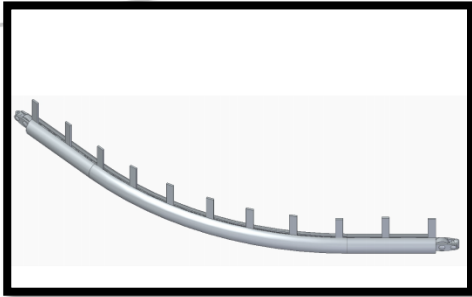

Horizontal Curve

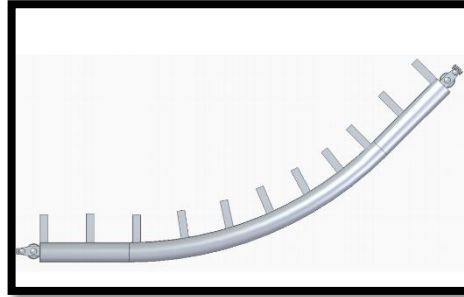

Vertical Curve Lower Bend

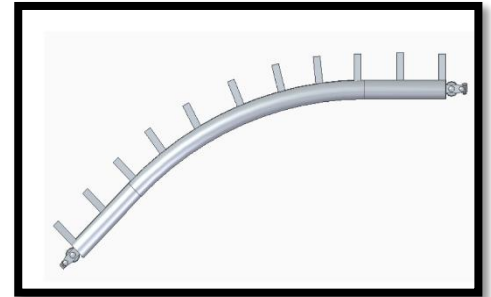

Vertical Curve Upper Bend

RAILEX SYSTEM 420 STANDARD COMPONENTS	
TRACK AND CHAIN	
421-20ZP	TRACK 12 GA SLOTTED ZINC PLATED 20 FT
421-20SS	TRACK 12 GA SLOTTED STAINLESS STEEL 20 FT
421-C3P	CHAIN WITH PENDANTS EVERY 3-1/8"
421-C6P	CHAIN WITH PENDANTS EVERY 6-1/4"
421-C3UC	CHAIN WITH CACTUS PENDANT EVERY 3-1/8"
421-C6UC	CHAIN WITH CACTUS PENDANT EVERY 6-1/4"
CURVES 18" AND 24" RADIUS STANDARD: ALL CURVES ARE 12 GA STAINLESS STEEL	
422-15H	CURVE STAINLESS 15 DEGREE HORIZONTAL
422-30H	CURVE STAINLESS 30 DEGREE HORIZONTAL
422-45H	CURVE STAINLESS 45 DEGREE HORIZONTAL
422-60H	CURVE STAINLESS 60 DEGREE HORIZONTAL
422-90H	CURVE STAINLESS 90 DEGREE HORIZONTAL
422-180H12	CURVE STAINLESS 180 DEGREE HORIZONTAL 12" RADIUS
422-180H18	CURVE STAINLESS 180 DEGREE HORIZONTAL 18" RADIUS
423-15V U OR L	CURVE STAINLESS 15 DEGREE VERTICAL UPPER OR LOWER
423-30V U OR L	CURVE STAINLESS 30 DEGREE VERTICAL UPPER OR LOWER
423-45V U OR L	CURVE STAINLESS 45 DEGREE VERTICAL UPPER OR LOWER
423-60V U OR L	CURVE STAINLESS 60 DEGREE VERTICAL UPPER OR LOWER
423-90V U OR L	CURVE STAINLESS 90 DEGREE VERTICAL UPPER OR LOWER
TRANSFER STATIONS - MOVING GOH ON AND OFF CONVEYOR	
424-TFON-L OR R	TRANSFER STATION ON FIXED LEFT OR RIGHT
424-TSON-L OR R	TRANSFER STATION ON SUSPENDED LEFT OR RIGHT
424-TPON-L OR R	TRANSFER STATION ON PNEUMATIC LEFT OR RIGHT
424-TFOFF-L OR R	TRANSFER STATION OFF FIXED LEFT OR RIGHT
424-TSOFF-L OR R	TRANSFER STATION OFF SUSPENDED LEFT OR RIGHT
424-TPOFF-L OR R	TRANSFER STATION OFF PNUMATIC LEFT OR RIGHT
DRIVE UNIT - 180 DEGREE WITH SCREW TYPE TAKE UP	
425-D180-12	DRIVE 180 DEGREE SCREW TAKE UP 12" DIAMETER
425-D180-18	DRIVE 180 DEGREE SCREW TAKE UP 18" DIAMETER
425-D180-24	DRIVE 180 DEGREE SCREW TAKE UP 24" DIAMETER
IDLER UNIT - 180 DEGREE	
425-I180-12	IDLER 180 DEGREE WITH 12" DIAMETER
425-I180-18	IDLER 180 DEGREE WITH 18" DIAMETER
425-I180-24	IDLER 180 DEGREE WITH 24" DIAMETER



Key Features:

- An enclosed track conveyor (ET) that is manufactured from 12 gauge zinc plated steel or stainless steel.
- All turns are hardened and machined stainless steel.
- Typical line speed of 18 to 45 feet per minute.
- Motor and gearing sized for each installation size and load requirements.
- The chain is made from hardened and corrosion resistant links and pushers.
- Each drive features a torque limiter for over-load protection.
- The chain is designed to operate in temperatures as high as 300 degrees F and 100% humidity.
- All 180 degree drives feature a screw-type take up for proper slack adjustment.
- Add-on Features such as welding clamps, hangers, non-melt chain lubricant, and pneumatic loading and un-loading are available.
- Complete controls, inverters, safety warnings, and operational sensor systems are available for your particular installation.



System 420 being used in retail display.

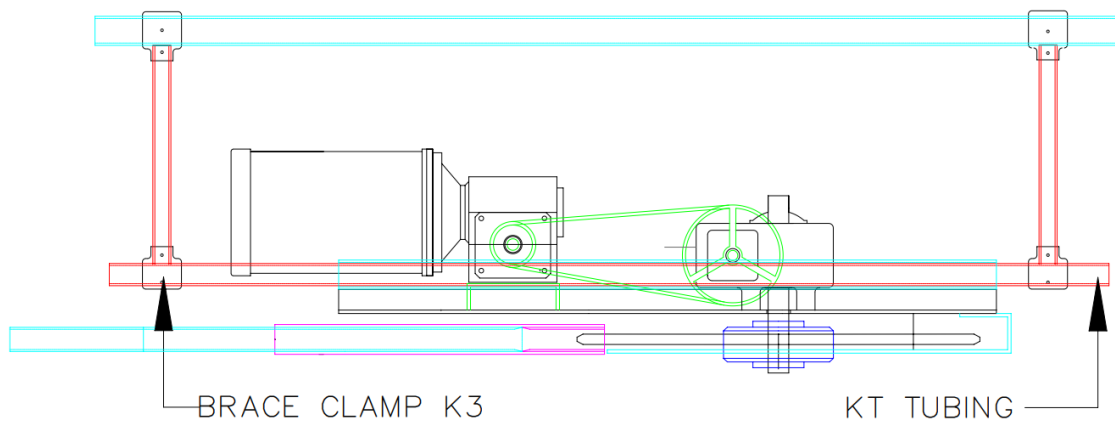

System 420 typical drive suspension.