

OWNERS MANUAL
SYSTEM 570
VERTICAL GARMENT AND TROLLEY LIFT



READ INSTRUCTIONS CAREFULLY BEFORE ATTEMPTING TO UNCRATE OR OPERATE THIS MACHINE

1. AFTER UNCRATING, INSTALL UPRIGHTS INTO LOWER SECTION WITH BOTTOM OF LIFT 4 FEET ABOVE FLOOR.
2. SET UP VERTICALLY IN PLACE AND BOLT SECURELY TO THE FLOOR.
3. PLACE UPPER SECTION OVER LOWER SECTION AND BOLT TOGETHER.
4. BRACE UPPER FRAME TO WALL OR OVERHEAD STRUCTURE.
5. CONNECT UPPER AND LOWER CHAIN TOGETHER USING CONNECTING LINKS.
6. CHECK ELECTRICAL SUPPLY VOLTAGE AND PHASE AND CONNECT ELECTRICAL SUPPLY.
7. ADJUST UPPER AND LOWER STOPPING POSITIONS BY RELOCATION ACTUATOR ON THE CHAIN.

MANUFACTURED BY
RAILEX CONVEYOR CORPORATION

SYSTEM 570 COMPONENTS

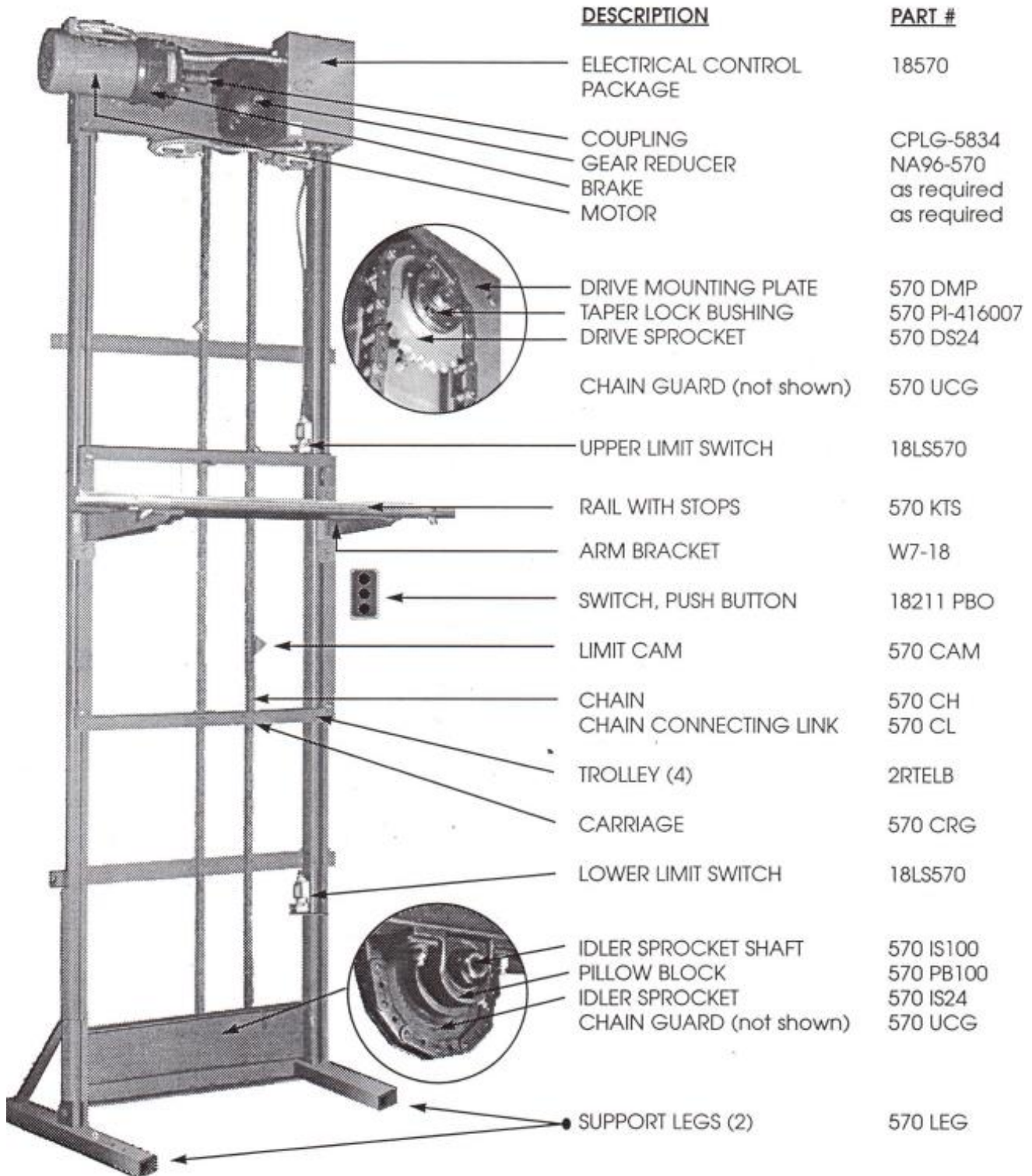

SYSTEM 570 OVERVIEW

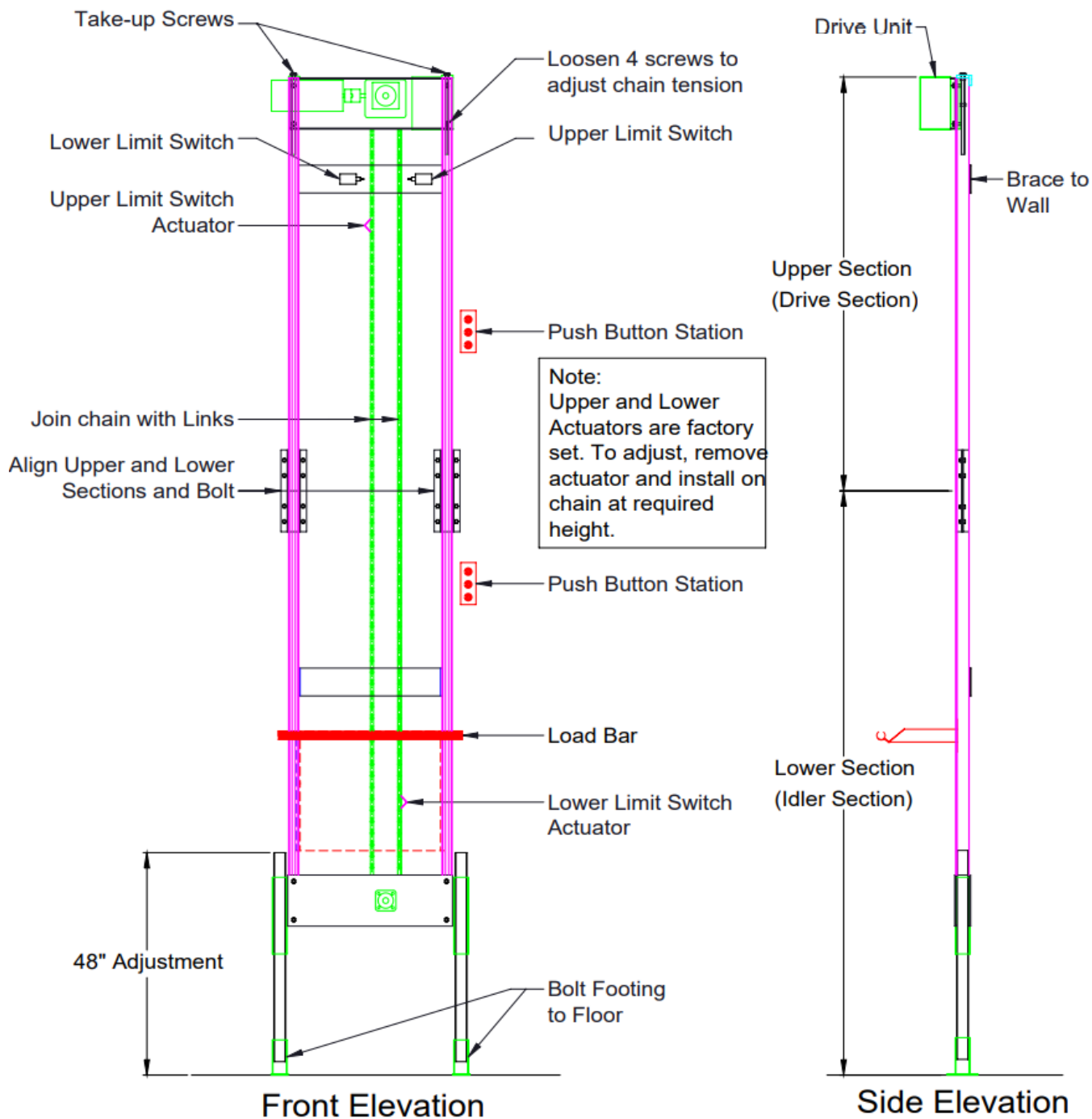

SYSTEM 570 OVERVIEW

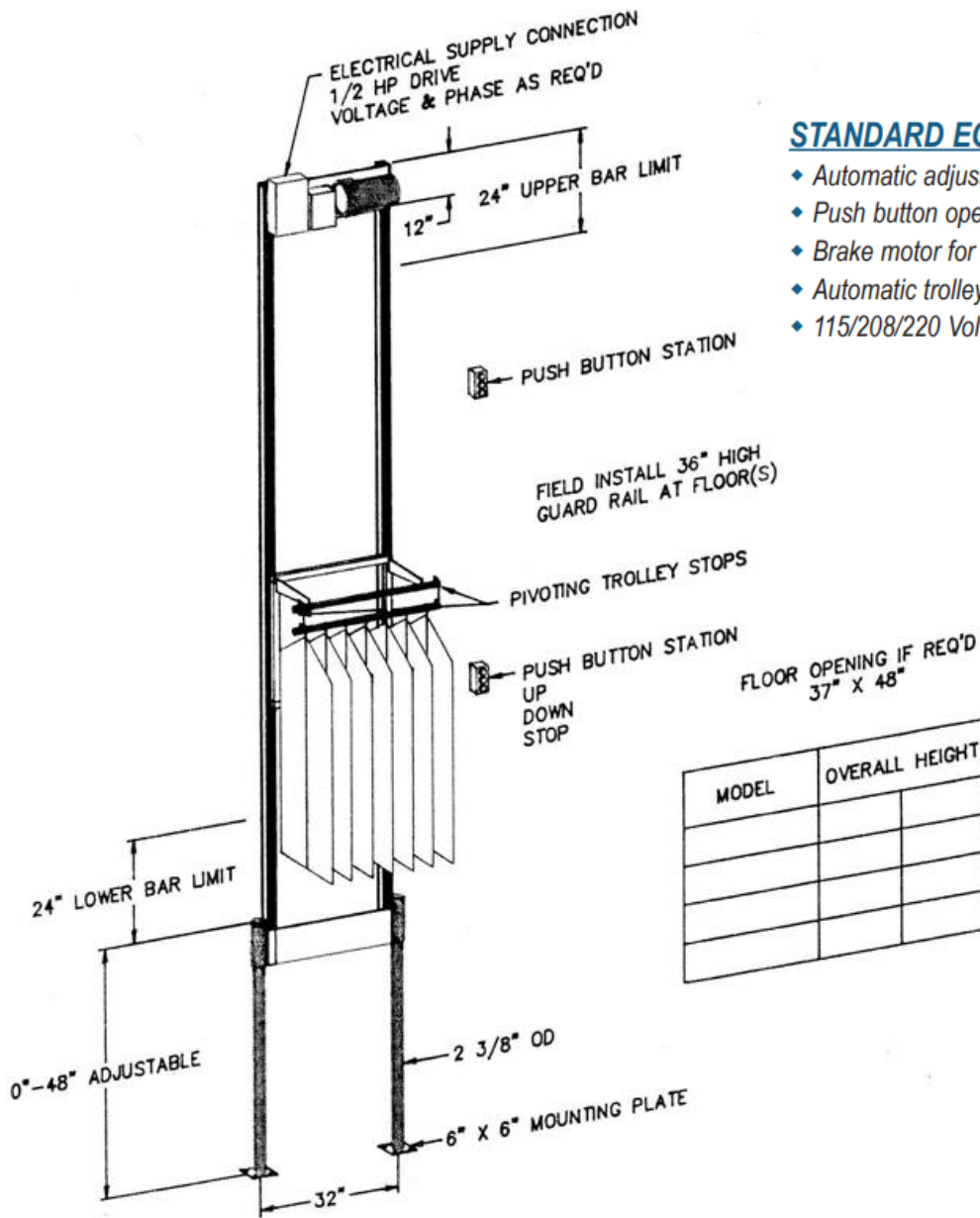

STANDARD EQUIPMENT

- ◆ Automatic adjustable stops for both levels
- ◆ Push button operation
- ◆ Brake motor for accurate positioning
- ◆ Automatic trolley entry stops
- ◆ 115/208/220 Volt; 1 or 3 ϕ

MODEL	OVERALL HEIGHT	UPPER TROLLEY

MODEL	OVERALL HEIGHT		* UPPER TROLLEY A.F.F.		SHIPPING WEIGHT IN POUNDS
	MIN.	MAX.	MIN.	MAX.	
570T10	10'	14'	15'	19'	635
570T15	15'	19'	13'	17'	685
570T20	20'	24'	18'	22'	735

* ABOVE LOWER FLOOR

SYSTEM 570 DIMENSIONS

MODEL	OVERALL HEIGHT		MAXIMUM LIFTING HEIGHT(TROLLEY)
	MIN.	MAX.	
570-T10	10'-0"	14'-0"	
570-T15	15'-0"	19'-0"	
570-T20	20'-0"	24'-0"	

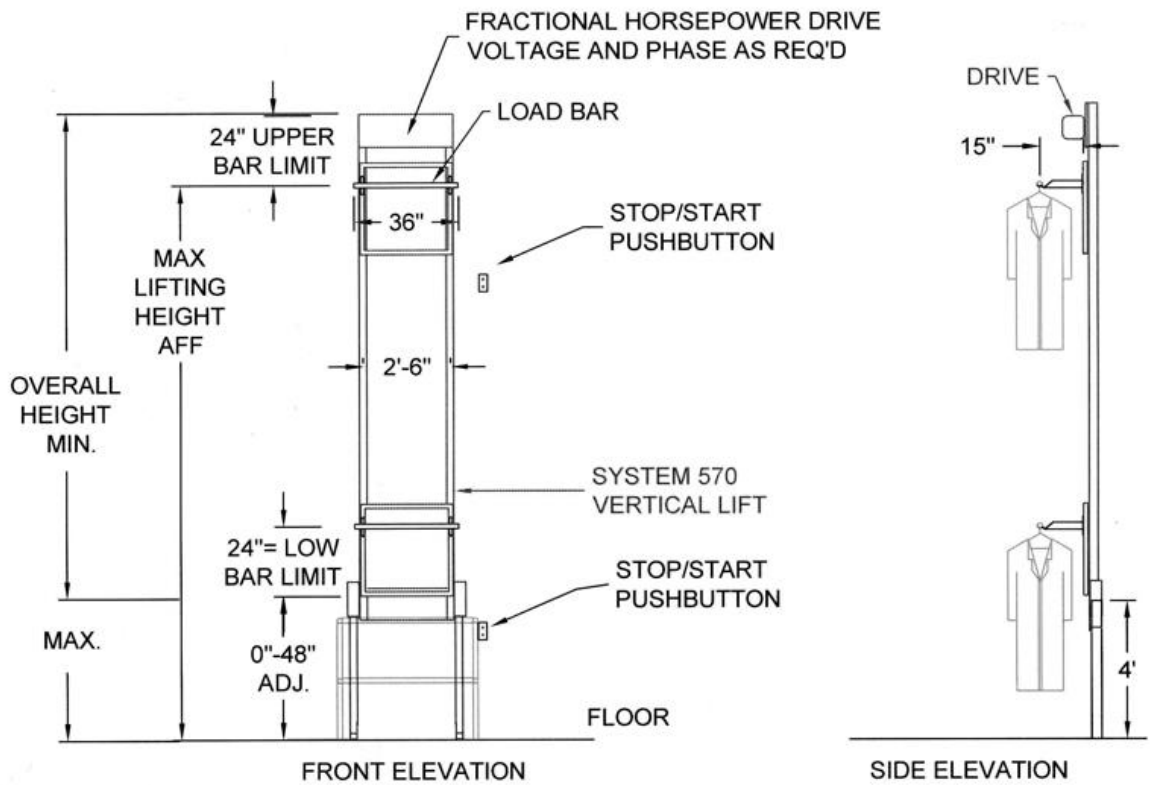

SYSTEM 570 TYPICAL LAYOUT

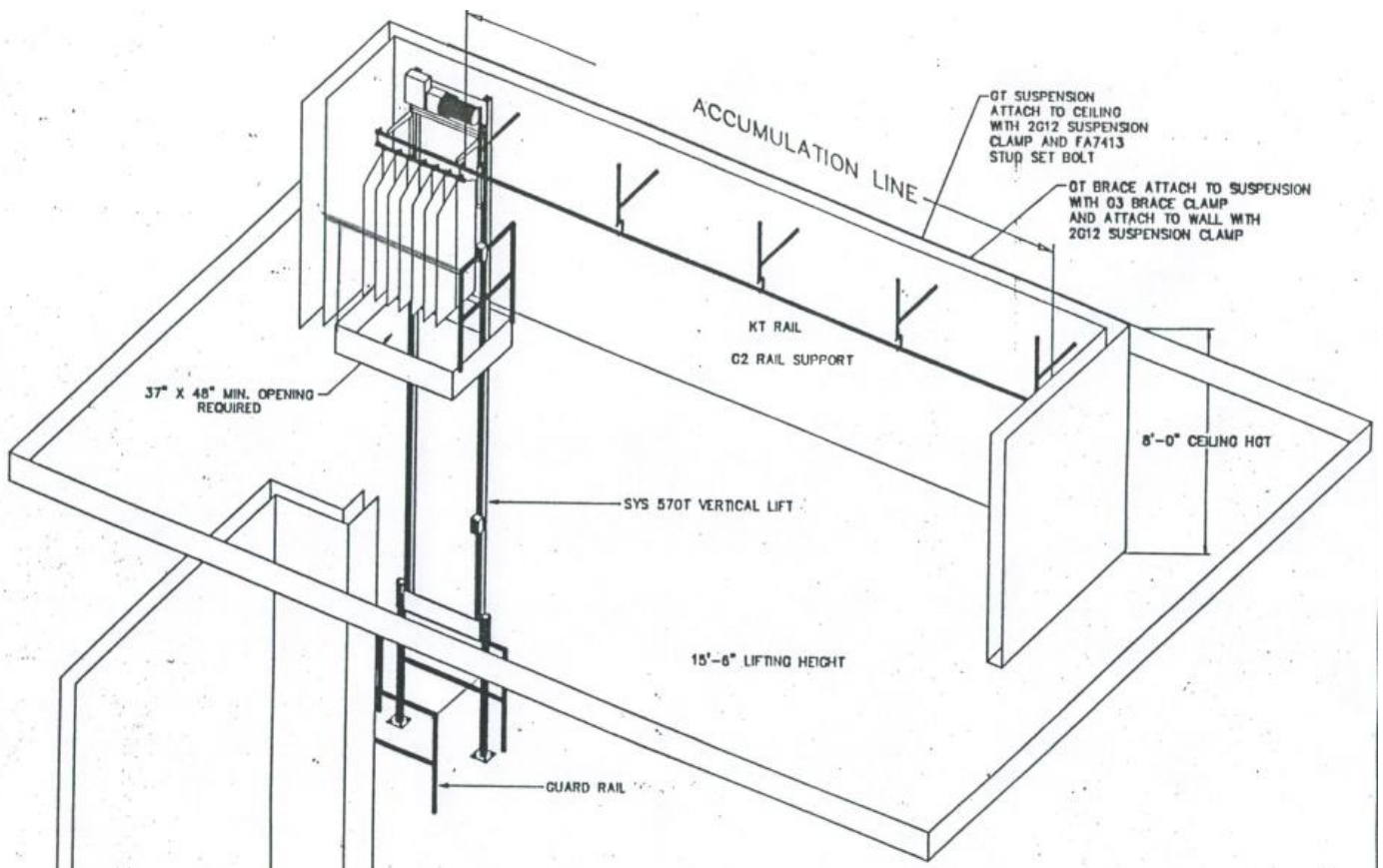

SYSTEM 570 METHOD OF OPERATION:

1. FROM SECOND FLOOR, GARMENTS ARE SORTED AND PLACED ON TROLRIES STAGED ON THE RAIL CONNECTED TO SYSTEM 570 VERTICAL LIFT.
2. OPERATER INITIATES THE SYSTEM 570 TO BRING INDIVIDUAL TROLRIES DOWN TO FIRST FLOOR.
3. TROLLEY ON SYSTEM 570 WILL STOP AUTOMATICALLY ON FIRST FLOOR, OPERATER ON FIRST FLOOR WILL PUSH LOADED TROLLEY AWAY FROM VERTICAL LIFT TOWARDS STORAGE LINES.
4. OPERATER WILL PUSH TROLLEY (IES) TO THE REQUIRED STORAGE LINE.
5. TROLRIES ARE NOW READY TO BE LOADED ON TRUCKS WITH SYSTEM 1341 TROLLEY TRANSFER RACKS, 2 TROLRIES CAN BE TRANSPORTED ON RACK.
6. RETURN OF EMPTY TROLRIES TO BE TRANSPORTED BACK WITH SYSTEM 1364 EMPTY TROLLEY TRANSPORTER RACK.

SYSTEM 570 MAINTENANCE

1. BEFORE MAKING ANY REPAIRS OR ADJUSTMENTS, BE SURE TO DISCONNECT THE POWER SUPPLY.
2. CHANGE GREASE IN TRANSMISSION GEAR REDUCER EVERY 12 MONTHS. USE RAILEX LUBRICANT 1505-2 OR EQUAL.
3. PERIODICALLY WIPE WITH A CLEAN CLOTH, AREA AROUND TRANSMISSION GEAR REDUCER SHAFT SEALS TO REMOVE ANY DIRT AND OIL THAT MAY HAVE FORMED.
4. IN SOME AREAS, DUE TO CONDITIONS OF DUST, LINT, HUMIDITY, ETC, A LIGHT FILM LUBRICANT MAY BE DESIRABLE ON A RAIL SURFACE. USE RAILEX LUBRICANT 22AFS OR EQUAL.
5. CONVEYOR HAS BEEN DESIGNED TO OPERATE NOISELESSLY, WITHOUT SQUEAKING OR GRINDING. IF ANY NOISE OF ANY TYPE SHOULD DEVELOP, CHECK SOURCE AND CORRECT CONDITION TO PREVENT FURTHER POSSIBLE DAMAGE.
6. ADJUST CHAIN TENSION IF EVIDENCE OF SLACK CHAIN.

BELT

BELT SHOULD BE TIGHTENED JUST ENOUGH TO PREVENT SLIPPING.

LUBRICATION

ALL MOTORS ARE LUBRICATED FOR THE LIFE OF THE BEARINGS.

CLEANING

KEEP THE MOTOR CLEAN AND DRY. OCCASIONALLY, BLOW THE DUST AND LINT OUT OF THE MOTOR. FREQUENCY WILL DEPEND ON DUST AND LINT CONDITIONS IN LOCATION.